

06" C509 FLG X FLG

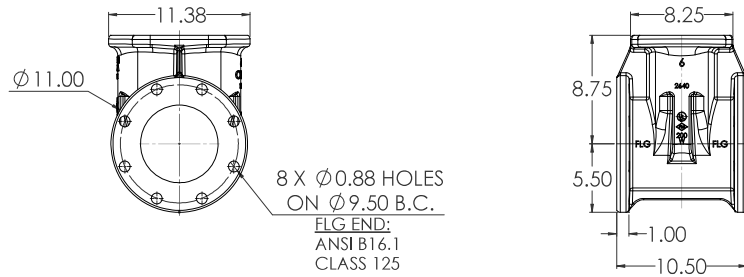

06" C509 FLG X TYTON

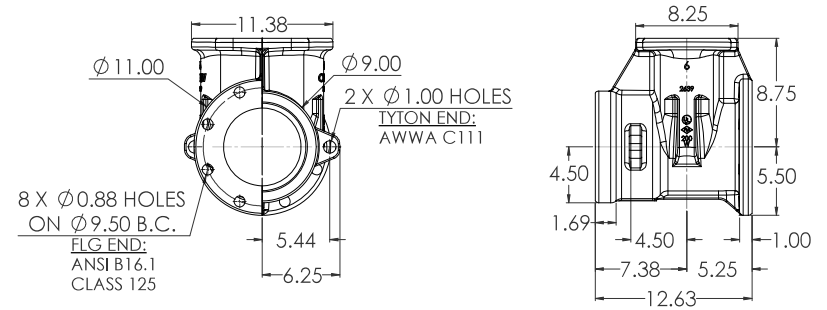

06" C509 FLG X MJ

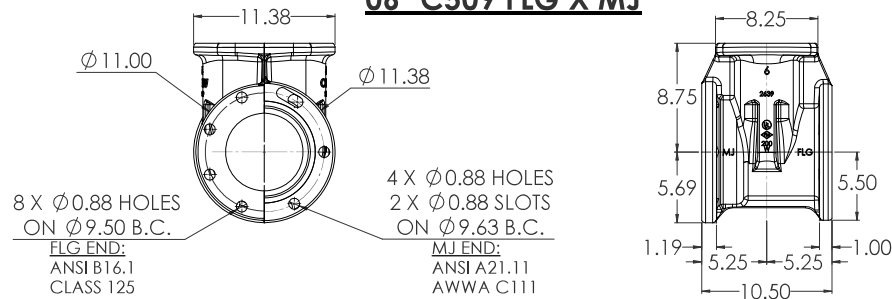

06" C509 MJ X MJ

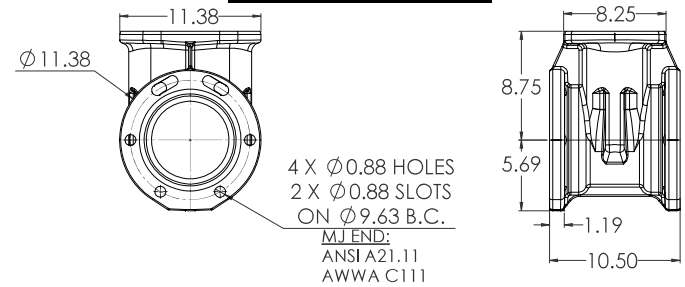

06" C509 TYTON X TYTON

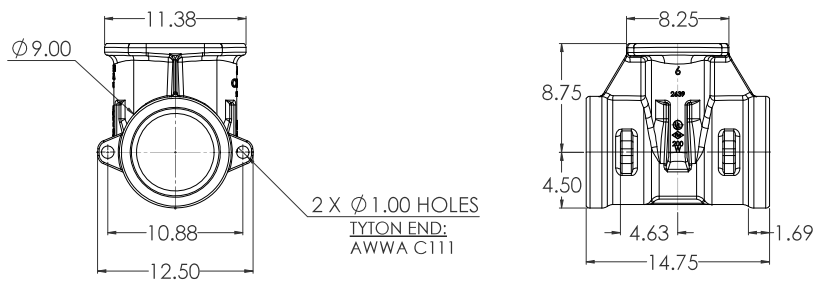

06" C509 PVC X PVC

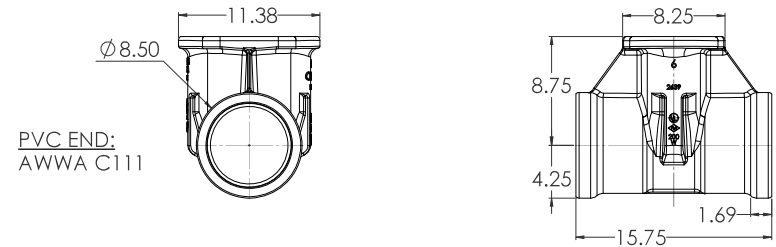

COMPANY: WORLDWIDE VALVE COMPANY ADDRESS: 1000 W. 10TH AVE., SUITE 100 DENVER, CO 80202 PHONE: 303.733.1100 FAX: 303.733.1101 WWW: WWW.WORLDWIDEVALVE.COM		PRODUCT: 06" C509 NRS GEARED RESILIENT WEDGE GATE VALVE LBS: 1500 CLASS: 125 END: 6		6
DATE: 01/01/2020 DRAWN BY: CW	CHECKED BY:	SCALE: 1:5	SHEET NO: 6 OF 6	

BEVEL GEAR WITH OPERATING NUT

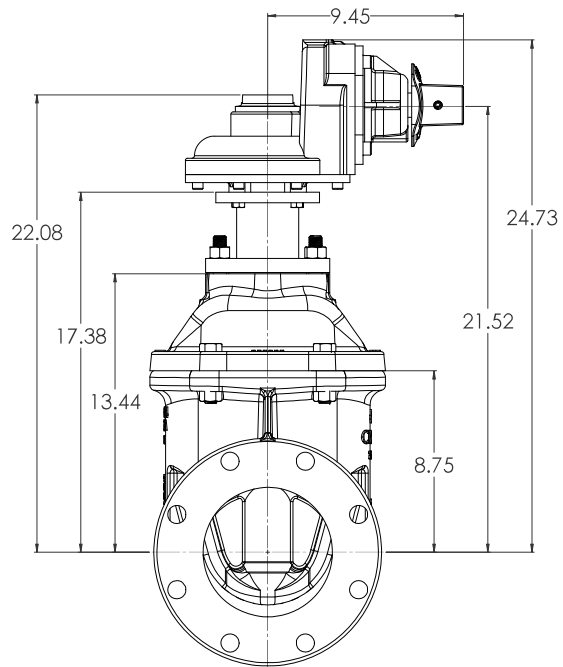

SPUR GEAR WITH OPERATING NUT

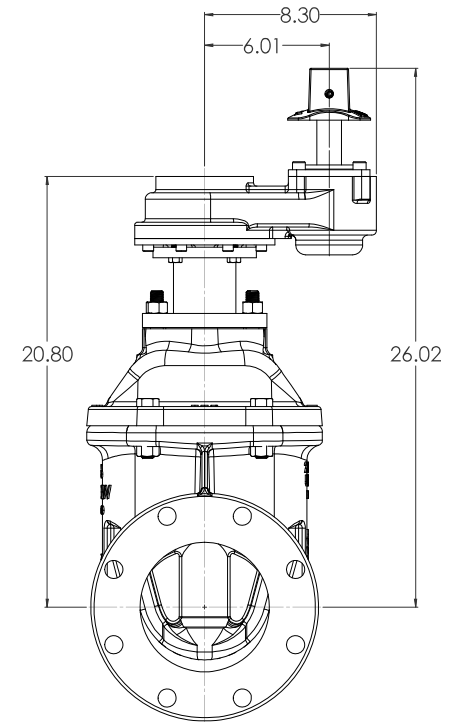

REVISED (DATE) (BY) (REASON) 10/01/2008 CW		DESCRIPTION 06" C509 NRS GEARED RESILIENT WEDGE GATE VALVE		SCALE 1:5		DATE 10/01/2008		PROJECT SalsWorks 2016 SP2		APPROVED 		DATE 10/01/2008		PROJECT SalsWorks 2016 SP2	
DATE 10/01/2008		BY CW		CHECKED 		DATE 10/01/2008		PROJECT SalsWorks 2016 SP2		APPROVED 		DATE 10/01/2008		PROJECT SalsWorks 2016 SP2	
DATE 10/01/2008		BY CW		CHECKED 		DATE 10/01/2008		PROJECT SalsWorks 2016 SP2		APPROVED 		DATE 10/01/2008		PROJECT SalsWorks 2016 SP2	

BEVEL GEAR WITH OPERATING NUT

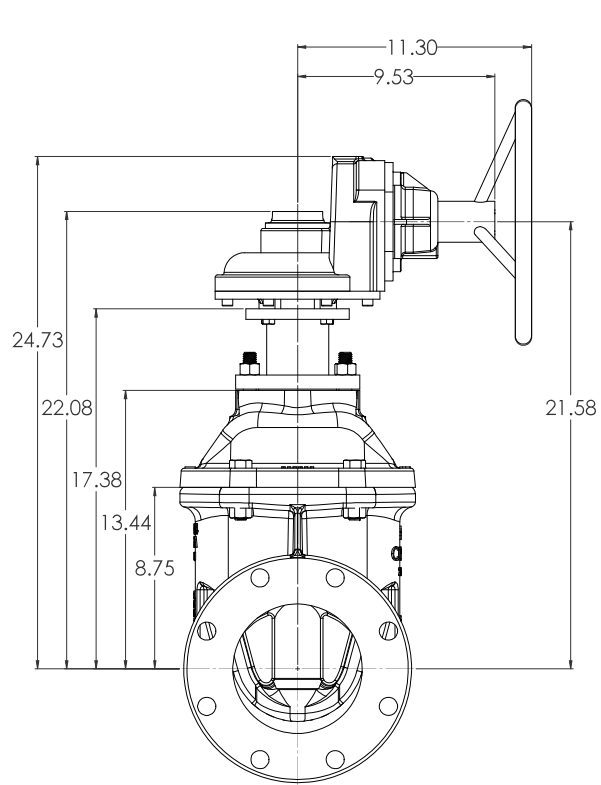

SPUR GEAR WITH OPERATING NUT

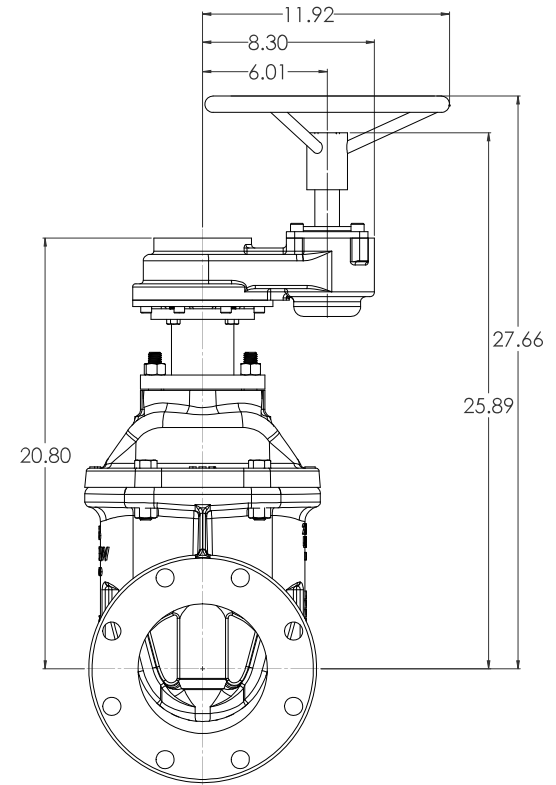

COMPANY: ME ADDRESS: 11111 111th Street, Suite 11111, Dallas, TX 75243 PHONE: 214-111-1111 FAX: 214-111-1111 E-MAIL: me@me.com WEBSITE: www.me.com		PROJECT: 06" C509 NRS GEARED RESILIENT WEDGE GATE VALVE LBS: 150 T: 1:5 DATE: 10/01/2020 DRAWN BY: CW CHECKED BY: [Signature] SCALE: 1:5 SHEET NO: 3 TOTAL SHEETS: 6		ME MECHANICAL ENGINEERING 3 6
---	--	---	--	--

BARE STEM ASSEMBLY

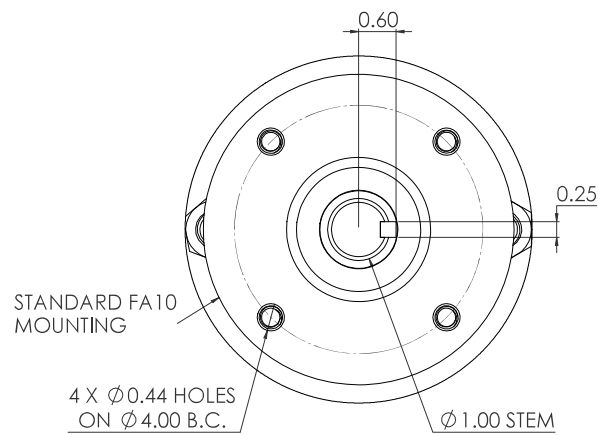
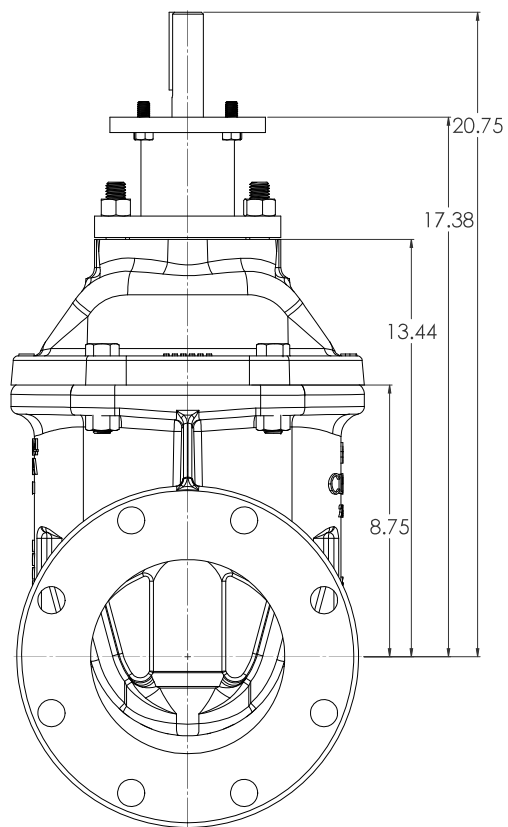

BARE STEM MOUNTING FLG

COMPANY: SOLOWORKS ADDRESS: 1000 W. 10TH AVENUE, SUITE 100 DENVER, CO 80202		PHONE: 303.733.8800 FAX: 303.733.8801 WWW: www.soloworks.com		DATE: 06/01/2020 TIME: 1:55	
PROJECT: 06" C509 NRS GEARED RESILIENT WEDGE GATE VALVE		DRAWING NO: LBS		SHEET NO: 4	
SCALE: 1:5		PROJECT NO: 2018 SP2		TOTAL SHEETS: 6	
DRAWN BY: CW		CHECKED BY: [Signature]		APPROVED BY: [Signature]	

<u>ITEM NO.</u>	<u>COMPONENT</u>	<u>QTY.</u>	<u>SIZE</u>	<u>STANDARD MATERIAL</u>	<u>MATERIAL OPTIONS</u>
1	BODY	1	-	CAST IRON	DUCTILE IRON
2	WEDGE	1	-	EPDM/DUCTILE IRON	-
3	STEM	1	-	C36000	C65500
4	THRUS WASHER	2	-	ACETAL	C26000
5	O-RING	3	#214	EPDM	BUNA-N
6	COVER	1	-	DUCTILE IRON	-
7	MOTOR MOUNT BRACKET	1	-	COLD ROLLED STEEL	-
8	STEM NUT	1	-	C87850	C87610 (LOW ZINC)
9	O-RING	1	#445	EPDM	BUNA-N
10	O-RING	1	#335	EPDM	BUNA-N
11	STEM KEY	1	1/4" X 2 1/2"	18-8 SS	316 SS
12	HEX HEAD CAP SCREW	4	3/8"-16 X 1"	18-8 SS	316 SS
13	BEVEL GEAR	1	-	-	SPUR GEAR
14	OPERATING NUT	1	-	CAST IRON	DUCTILE IRON, C86700, **10" DIA. HANDWHEEL**
15	COILED SPRING PIN	1	10MM X 45MM	18-8 SS	316 SS
16	HEX HEAD CAP SCREW	6	5/8"-11 X 2 1/4"	18-8 SS	316 SS
17	HEX NUT	4	5/8"-11	18-8 SS	316 SS
18	HEX NUT	2	5/8"-11	18-8 SS	316 SS

- VALVES CONFORM WITH THE FOLLOWING STANDARDS
 - AWWA C509
 - NSF 61
- LOW ZINC BRASS STEM AND STEM NUT AVAILABLE
- 100% DOMESTIC FASTENERS AND ORINGS OPTIONS AVAILABLE
- *OPEN LEFT* (COUNTERCLOCKWISE) AND *OPEN RIGHT* (CLOCKWISE) OPTIONS AVAILABLE
- TURNS TO OPEN FROM FULLY CLOSED: 20
- AWWA MAXIMUM ALLOWABLE CLOSING TORQUE 110 FT-LBS INTO GEAR
- OPTIONAL HANDWHEEL CAN BE SUBSTITUTED FOR STANDARD 2" SQUARE OP. NUTS.
 - **NOTE: STANDARD HANDWHEEL SIZE LISTED OUT IN PARTS LIST.**

REVISED DATE: 10/01/2020 BY: CW		DESCRIPTION 06" C509 NRS GEARED RESILIENT WEDGE GATE VALVE		SCALE 1:10	DATE 10/01/2020	BY CW	APP'D 	DATE 10/01/2020	BY 
--	--	--	--	----------------------	---------------------------	-----------------	---	---------------------------	--