

When placing orders or making inquiries, please furnish the following information. This information will enable us to answer your questions, prepare quotations, and fill your order promptly. Lack of essential information is almost sure to cause delays.

Use Figure Number where possible to identify the product wanted

1. Quality and style.
2. Construction: Safety Flange.
3. Size of main valve openings: 4 ½ or 5 ¼ inch.
4. Number and size of pumper nozzles.
5. Type of inlet connection: Flanged, mechanical joint, or Tyton [6"]
6. Size of inlet connection: 4-, 6-, or 8"
7. Depth of trench or bury: Distance from ground line to bottom of connecting pipe.
8. Direction of opening: Usually open to left (counterclockwise); open right (clockwise), when specified.
9. Size and shape of operating nut: National Standard is 1 ½ inch pentagon measured from point to opposite flat at base of nut.
10. Hose and pumper nozzle threads: If other than National Standard, thread specification and nut size must be furnished in the following manner:
 - (a): Send sample nozzle or male hose coupling; or
 - (b): Send drawing giving complete thread specification; or
 - (c): Refer us to previous hydrant order. Complete records are kept of all installations.
11. Color: Specify color of paint wanted.

Specifications

Clow, Eddy, Medallion, and Admiral Fire Hydrants meet or exceed the requirements of American Water Works Association Specification AWWA C502, Fire Hydrants for Ordinary Water Service.

Hose and Hydrant Wrenches

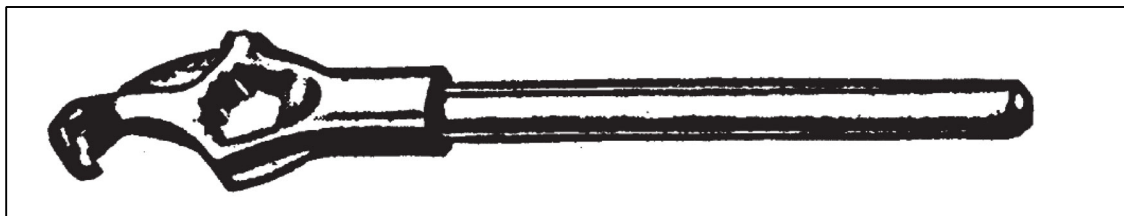

F-2750

Adjustable Hydrant Wrench with Spanner
Fits both Pin type and Rocker type hose couplings

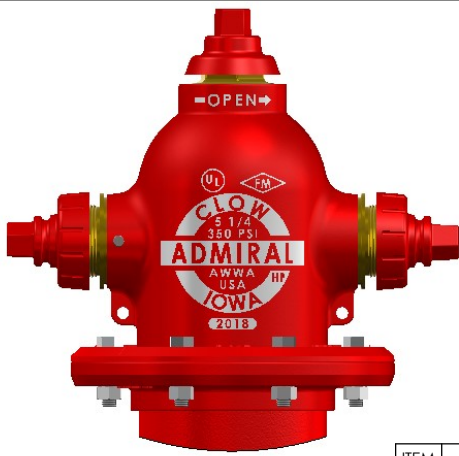

CLOW

Valve Company
 902 South 2nd St. Oskaloosa, IA 52577
 1-800-829-2569 info@clowvalve.com

Admiral Hydrant



Thrust Nut Lock Option
 *Standard for Open Right

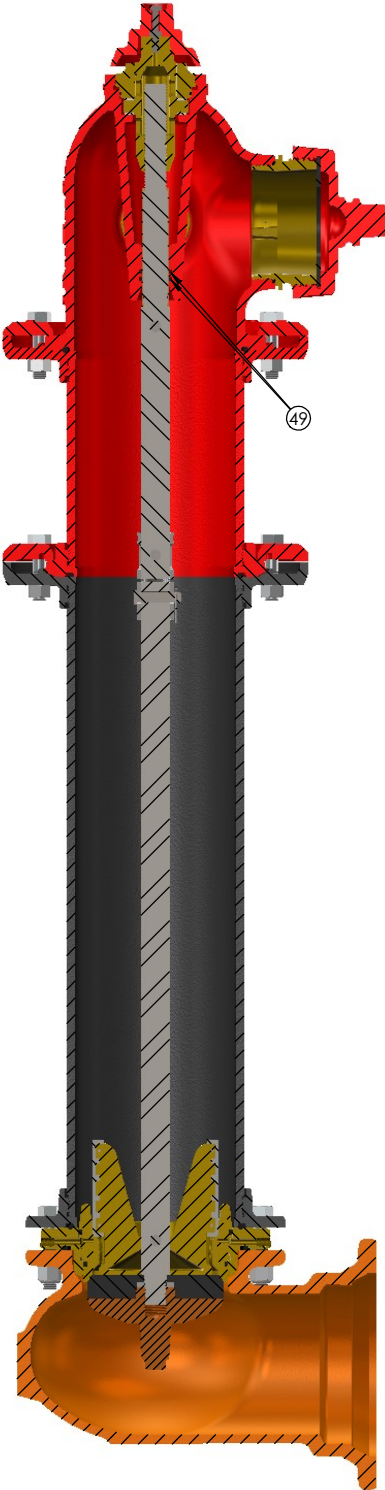

| ITEM NO. | DESCRIPTION | MATERIAL | QTY. |
|----------|--------------------------|------------------------|------|
| 1 | Hex Head Bolt | Stainless Steel | 1 |
| 2 | Weather Shield | Cast Iron | 1 |
| 3 | Thrust Nut | Copper Alloy | 1 |
| 4 | O-Ring # 151 | Rubber | 1 |
| 5 | Hydrant Body | Ductile Iron | 1 |
| 6 | Nozzle Lock Screw | Stainless Steel | 3 |
| 7 | O-Ring #235 | Rubber | 2 |
| 8 | Nozzle - Hose | Copper Alloy | 2 |
| 9 | Gasket - Hose | Neoprene | 2 |
| 10 | Cap - Hose | Cast Iron | 2 |
| 11 | O-Ring #444 | Rubber | 2 |
| 12 | Hex Bolt - 5/8" x 2 1/2" | Stainless Steel | 16 |
| 13 | Top Flange | Ductile Iron | 2 |
| 14 | Riser Top Flange | Ductile Iron | 1 |
| 15 | Hex Nut 5/8" | Stainless Steel | 16 |
| 16 | Riser Pipe | Ductile Iron | 1 |
| 17 | Safety Flange | Cast Iron | 2 |
| 18 | Riser Lower Flange | Ductile Iron | 1 |
| 19 | O-Ring #442 | Rubber | 2 |
| 20 | Stand Pipe Upper Flange | Ductile Iron | 1 |
| 21 | Stand Pipe | Ductile Iron | 1 |
| 22 | Hex Bolt - 5/8" x 3 1/4" | Stainless Steel | 8 |
| 23 | Stand Pipe Lower Flange | Ductile Iron | 1 |
| 24 | Drain Ring | Copper Alloy | 1 |
| 25 | Shoe | Ductile Iron | 1 |
| 26 | Lock Nut | Stainless Steel | 8 |
| 27 | O-Ring #131 | Rubber | 1 |
| 28 | Thrust Bearing | Plastic | 2 |
| 29 | Operating Nut | Copper Alloy | 1 |
| 30 | O-Ring #250 | Rubber | 1 |
| 31 | Nozzle - Steamer | Copper Alloy | 1 |
| 32 | Gasket - Steamer | Neoprene | 1 |
| 33 | Cap - Steamer | Cast Iron | 1 |
| 34 | Upper Stem Sleeve | Copper Alloy | 1 |
| 35 | Type E Groove Pin | Stainless Steel | 2 |
| 36 | Upper Stem | Cold Rolled Steel | 1 |
| 37 | Safety Coupling | Duplex Stainless Steel | 1 |
| 38 | Cotter Pin | Stainless Steel | 2 |
| 39 | Coupling Pin | Stainless Steel | 2 |
| 40 | Lower Stem | Cold Rolled Steel | 1 |
| 41 | Drain Slide | Plastic | 2 |
| 42 | Upper Valve Plate | Copper Alloy | 1 |
| 43 | O-Ring #361 | Rubber | 1 |
| 44 | Seat Ring | Copper Alloy | 1 |
| 45 | O-Ring #360 | Rubber | 1 |
| 46 | Valve Seat | Rubber | 1 |
| 47 | Lock Washer | Stainless Steel | 1 |
| 48 | Lower Valve Plate | Ductile Iron | 1 |
| 49 | O-Ring #218 | Rubber | 2 |

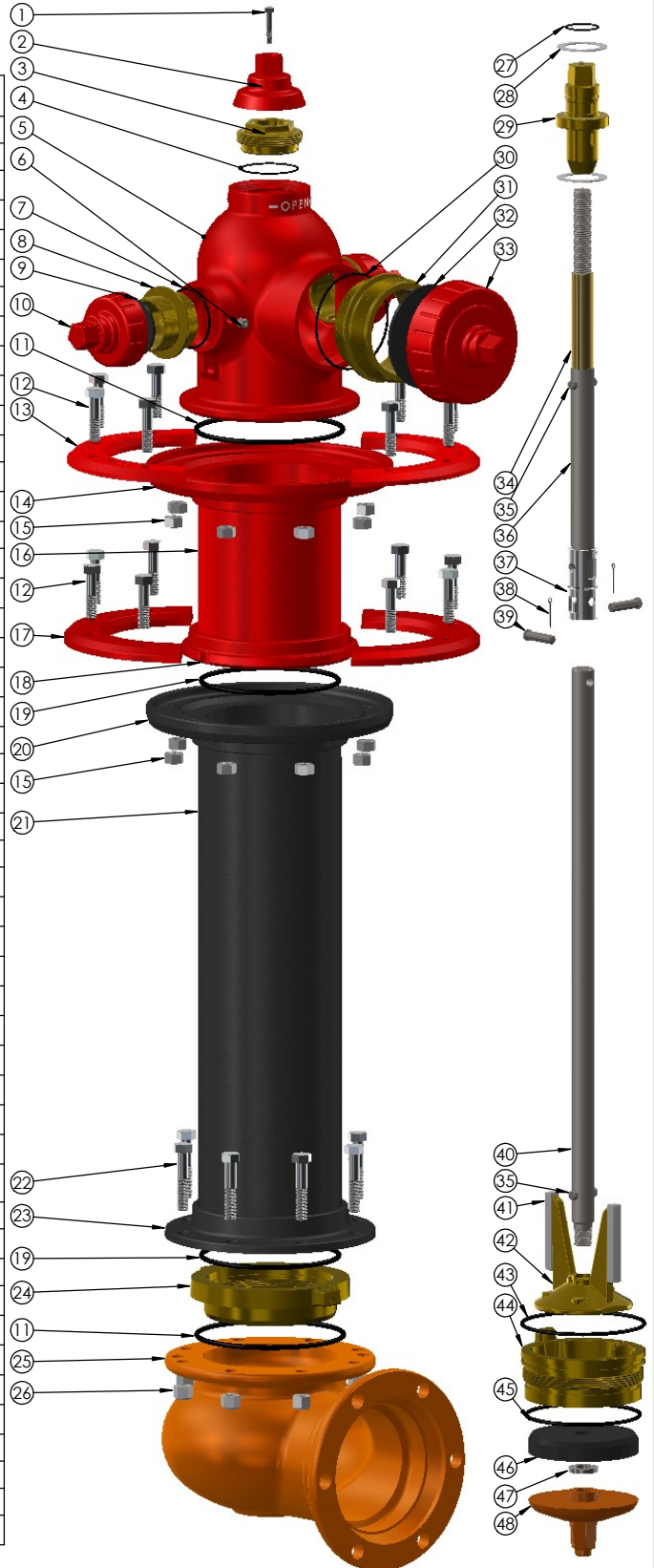

ADMIRAL HYDRANT
ASSEMBLY
CLOW VALVE COMPANY

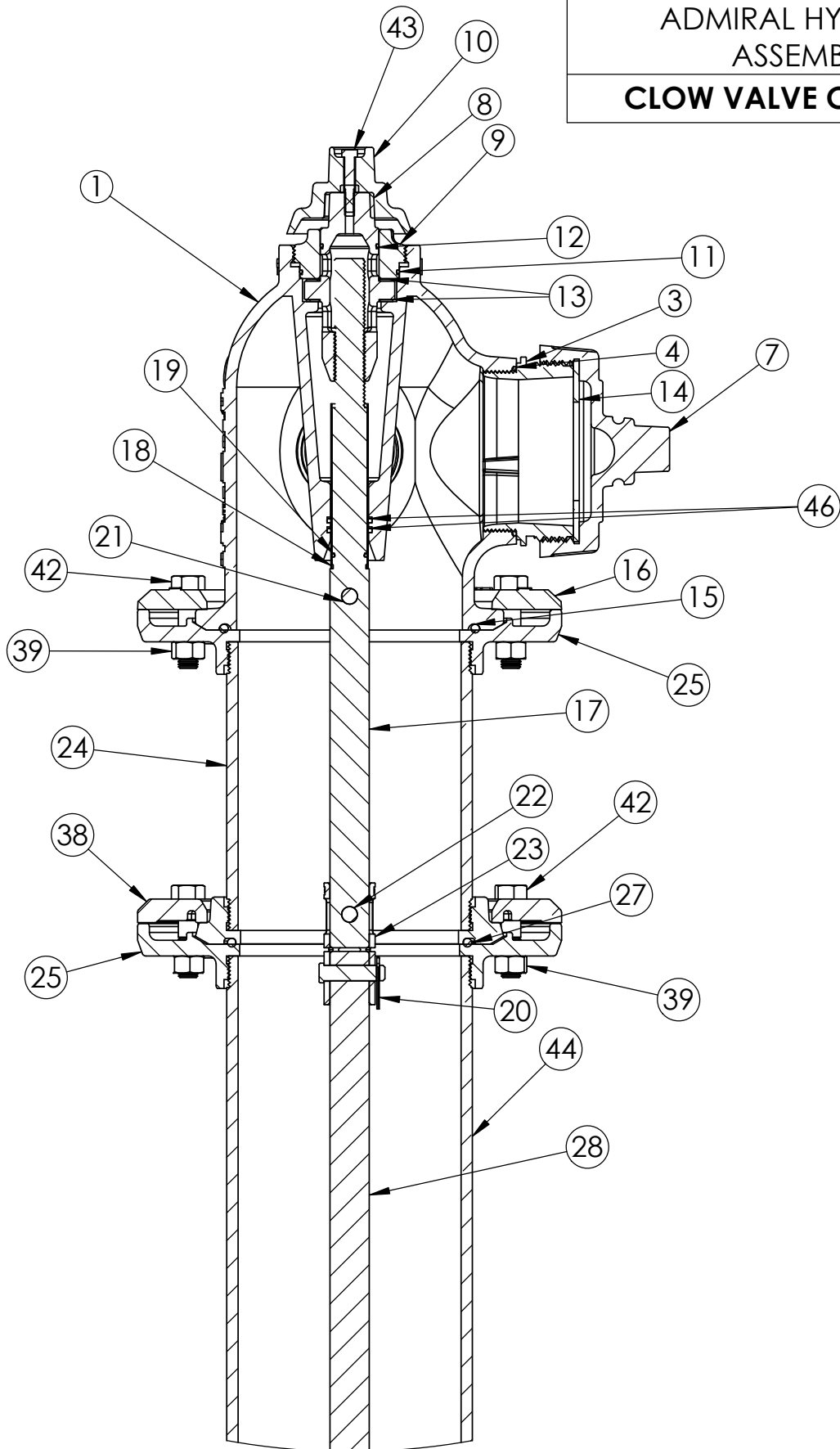

ADMIRAL HYDRANT
ASSEMBLY

CLOW VALVE COMPANY

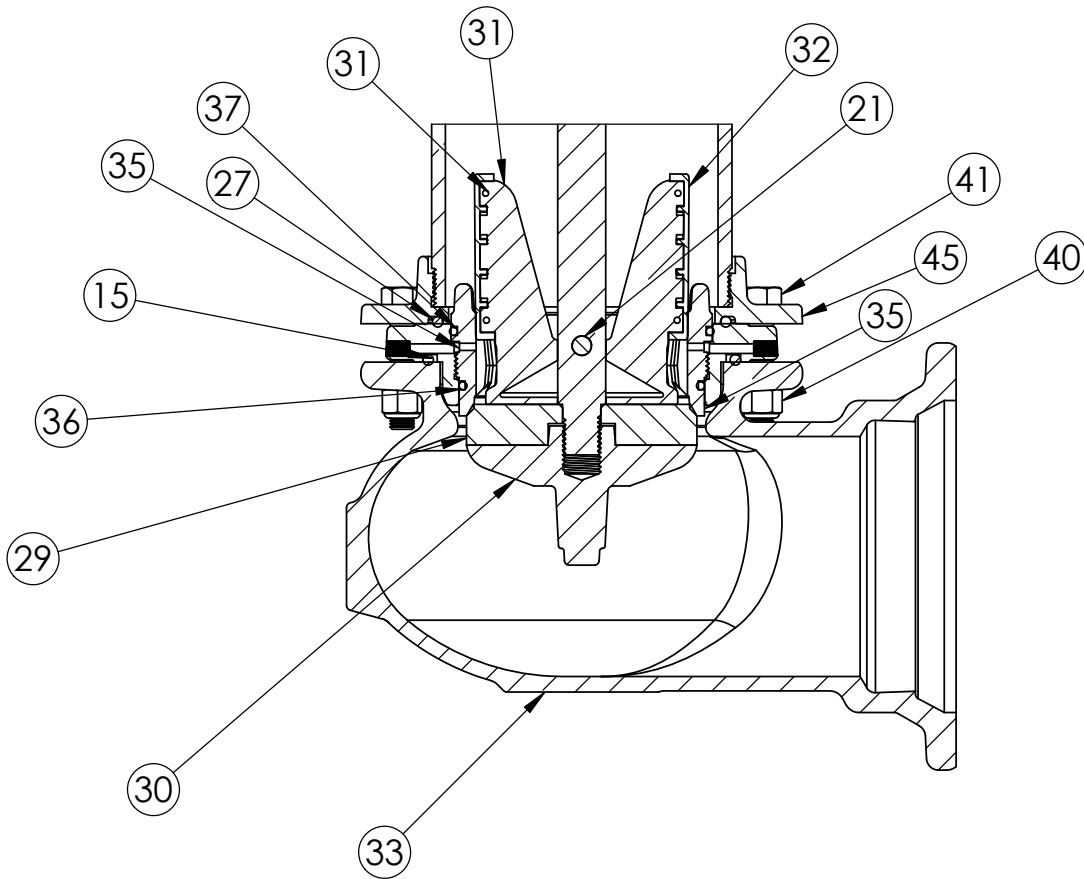

ADMIRAL HYDRANT
GENERAL DIMENSION LAYOUT

CLOW VALVE COMPANY

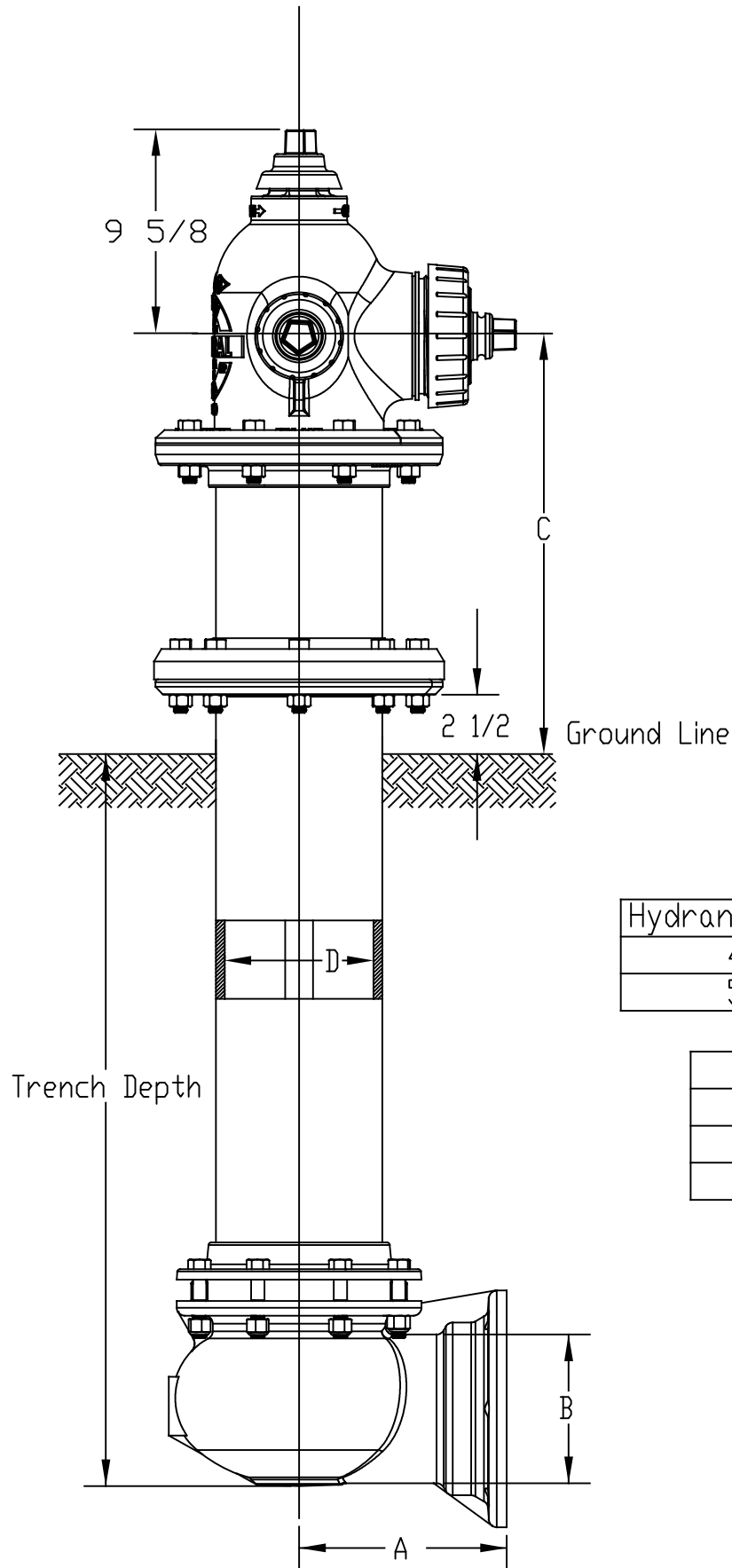

Dimension "C" is the "Above Ground Height" of nozzles; standard heights are 18" and 24" (others upon request)

| Hydrant Valve Size | D |
|--------------------|-----------|
| 4 1/2" | 6.16 ±.14 |
| 5 1/4" | 7.04 ±.14 |

| End Type | A |
|----------|--------|
| Flange | 10 1/8 |
| SMJ | 9 |
| Tyton | 9 5/8 |

| Inlet Size | B |
|------------|-------|
| 4" | 4 1/2 |
| 6" | 6 1/4 |
| 8" | 6 1/4 |

ADMIRAL HYDRANT
VERTICAL BOTTOM GENERAL DIMENSION LAYOUT

CLOW VALVE COMPANY

Hydrant complies with AWWA C502 & C550 standards.

Hydrant complies with UL 246 and FM standard.

Hydrant has a rated working pressure of 250 psig.

Dimension "C" is the "Above Ground Height" of nozzles; standard heights are 18" and 24" (others upon request)

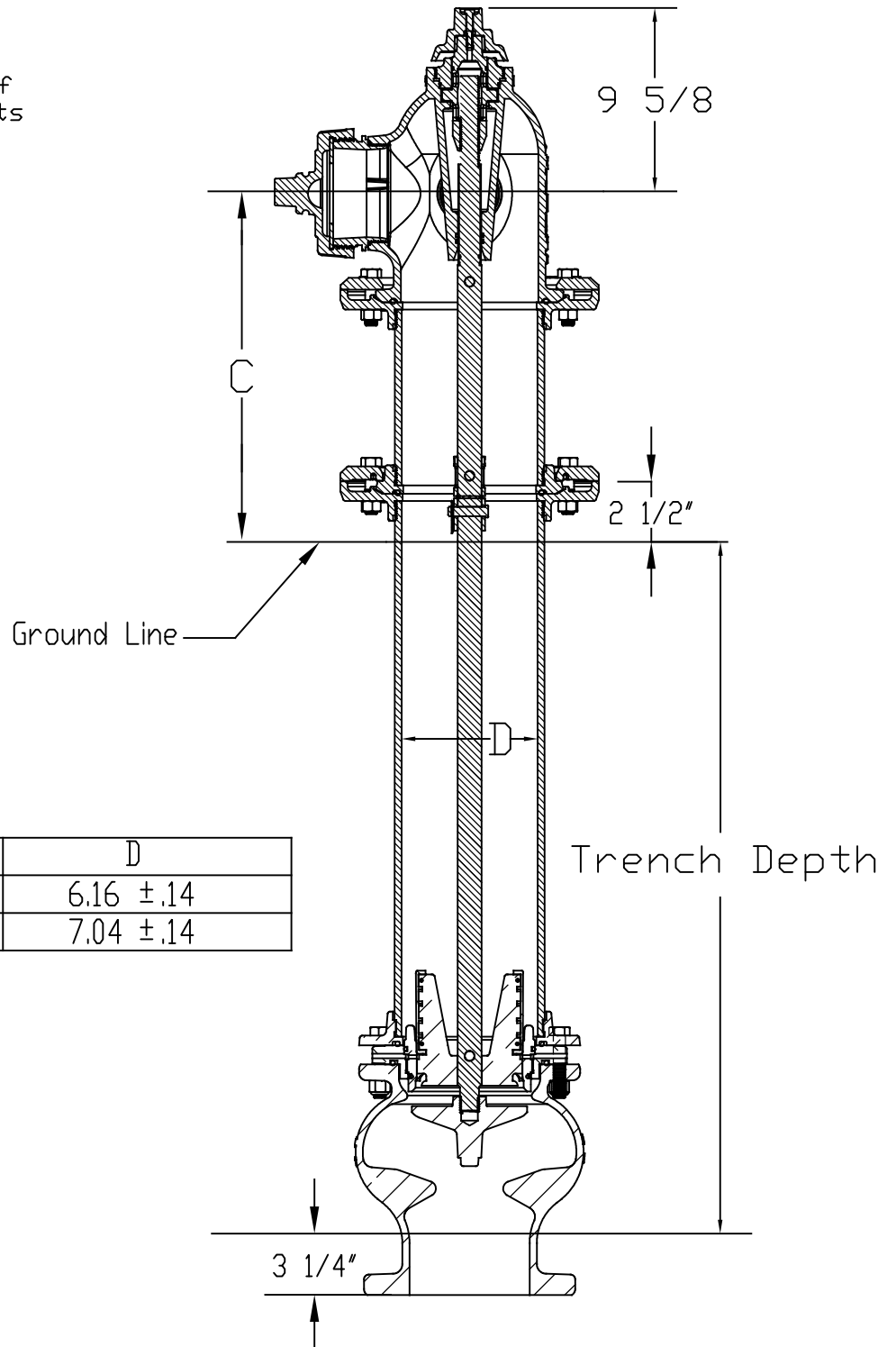

| Hydrant Valve Size | D |
|--------------------|-----------|
| 4 1/2" | 6.16 ±.14 |
| 5 1/4" | 7.04 ±.14 |

ADMIRAL HYDRANT
MAIN VALVE SEAT REMOVAL
HYDRANT WRENCH-BONNET STOP OPTION
CLOW VALVE COMPANY

Hydrant Wrench (T-160-0826)

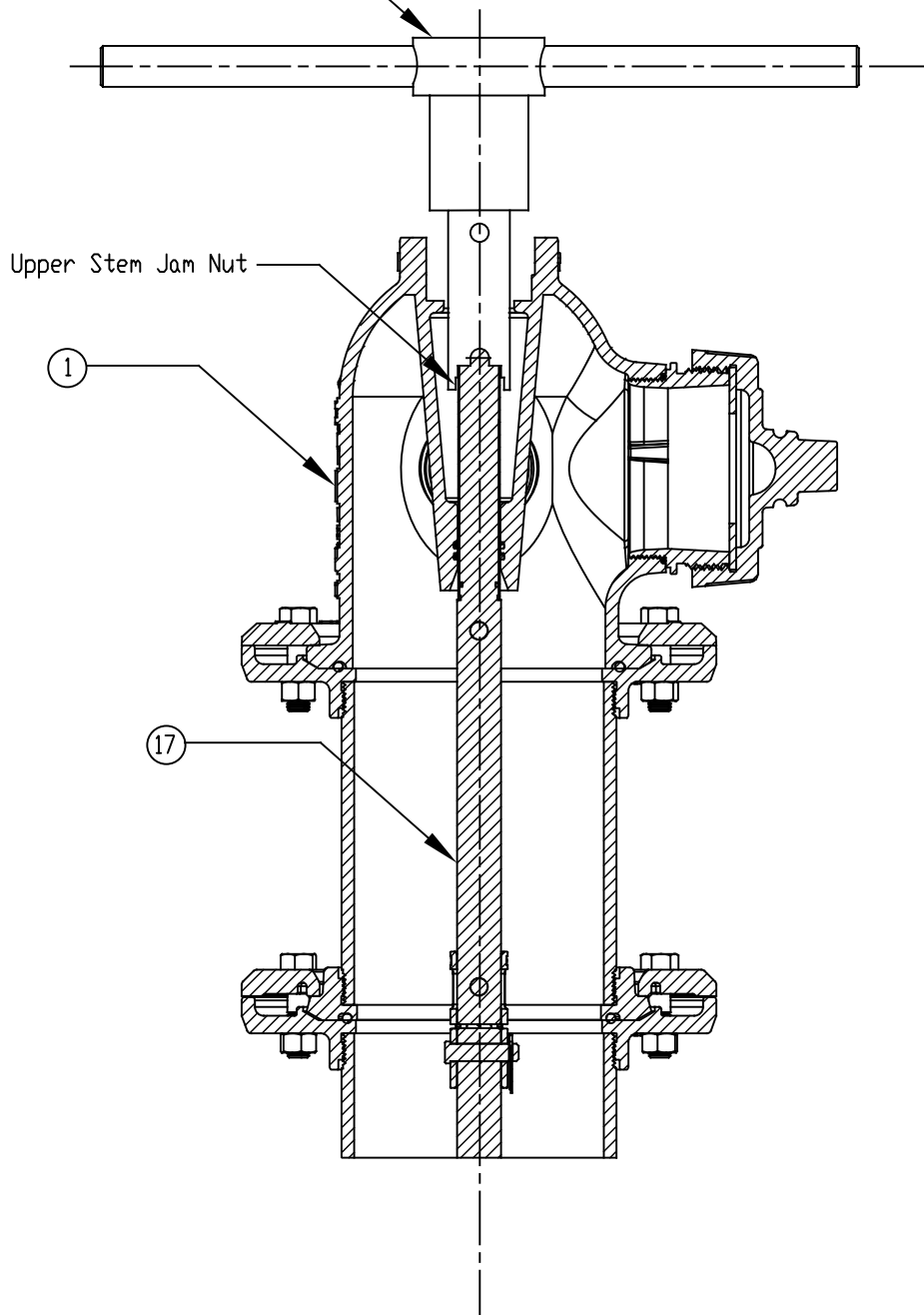

ADMIRAL HYDRANT
AWWA UL/FM
SAMPLE SPECIFICATIONS
CLOW VALVE COMPANY

1. Fire Hydrant shall be manufactured in accordance with AWWA Standard C502, be listed by Underwriters Laboratories, Inc. and have Factory Mutual Research approval.
2. Fire Hydrant shall be designed for 250 psi working pressure and tested to 500 psi Hydrostatic pressure.
3. Fire Hydrant shall be backed by manufactures 10 year limited warranty.
4. Fire Hydrant shall be dry top center stem construction having an O-Ring sealed lubrication reservoir.
5. Fire Hydrant shall be manufactured with operating nut and thrust nut made of copper alloy with bearings located both above and below the thrust collar and with operating nut protected by a cast iron weather shield.
6. Fire Hydrant shall be manufactured with nozzles mechanically locked into the barrel coupling. Nozzle section must rotate 360 degrees.
7. Fire Hydrant shall be a "Traffic Model" , complete with safety flanges and steel stem coupling. Nozzle section must rotate 360 degrees.
8. Fire Hydrant shall be manufactured with a main valve seat ring of copper alloy threaded into a copper alloy drain ring. A 360 degree drain channel shall have a minimum of two drain outlets.
9. Fire Hydrant shall have a copper alloy upper valve plate and two urethane rubber facings that activate the drain ports.
10. Fire Hydrant shall be manufactured with a lower valve plate that bottoms out in the shoe for maximum opening.
11. Fire Hydrant shall be manufactured with a minimum main valve opening of 4 ½ or 5 ¼ inches.
12. Fire Hydrant shall be the CLOW ADMIRAL as manufactured by the Clow Valve Company or approved equal.